



483

Package Contains:

1. Injection molded assembly: foaming barrel, handle, and eductor.
2. Concentrate container: Model 483 - 48 oz.
3. Suction tube/strainer.
4. Spray nozzle with quick disconnect assembly.
5. Metering tip kit.
6. Product information sheet.

THANK YOU FOR YOUR INTEREST IN OUR PRODUCTS

Please use this equipment carefully and observe all warnings and cautions.

*****NOTE*****

WEAR	protective clothing and eyewear when dispensing chemicals or other materials.
ALWAYS	observe safety and handling instructions of the chemical manufacturers.
ALWAYS	direct discharge away from you or other persons or into approved containers.
ALWAYS	dispense cleaners and chemicals in accordance with manufacturer's instructions. Exercise CAUTION when maintaining your equipment.
CLEAN	equipment after each use in accordance with instruction sheet.
WEAR	protective clothing and eyewear when working in the vicinity of all chemicals, filling or emptying equipment or changing metering tips.
ALWAYS	re-assemble equipment according to instruction procedures. Be sure all components are firmly screwed or latched into position.
ATTACH	only to tap water outlets (85 PSI maximum).

Operation:

1. Unscrew foamer lid assembly from container.
2. Select a colored tip based on your water pressure. Pink is for high water pressure, purple (most common) is for average water pressure and yellow is for low water pressure.
3. Press the small end of the colored tip firmly into the center of the hole on the bottom of the lid.
4. Attach the clear tube over the tip. Make sure the strainer screen is connected to the other end of the tube.
5. Fill your container with EZ All concentrate. Total Body Wash, Multi-Purpose or Truck & Trailer.
6. Attach the spray nozzle to your water hose and turn on water.
7. Gently pull back the quick connect collar on the spray nozzle (in the direction of the arrows) and attach to the lid.
8. Grip and squeeze the nozzle handle to apply the EZ All products as needed. It will appear as a light white foam and dissipate fairly quickly. After foaming on product, disconnect the spray nozzle from the applicator by pulling the arrows on the quick disconnect in the opposite direction to release the nozzle. Rinse thoroughly.
9. **Important Note:** When using Truck & Trailer light agitation is required with a soft brush to loosen dirt prior to rinsing.

Thank you for becoming part of the EZ All Team. You are our #1 priority. For customer service please feel free to call us Monday- Friday 9AM-5PM EST at 877-879-3925 (877-TRY-EZAL) You may visit us on the web at www.ezall.com for more information, Frequently asked Questions and to find a dealer most convenient for you. Again, we appreciate your trust in EZ All.

Troubleshooting:

Problem	Cause	Remedy
1. Unit does not draw concentrate	a. Clogged suction tube strainer b. Metering tip orifice obstructed c. Water pressure too low d. Mineral deposits in barrel of foamer	a. Clean or replace b. Rinse tip or replace: Do not attempt to clean: may alter size of orifice c. Minimum 25 PSI required d. Back flush unit. Remove container, suction tube and metering tip. Put finger over barrel opening. Apply minimal water pressure through garden hose at nozzle of barrel to be flushed. d. Descale foamer by soaking in weak descaling solution. e. Clean or replace strainer.
2. Weak foaming action	e. Clogged water inlet strainer (low water flow) a. Clogged water inlet strainer b. Water pressure too low c. Water temperature too high	a. Clean or replace b. Minimum 25 PSI required c. Use lower temp water source. (Concentrate flow decreases above 140° F water)

If above steps fail to produce good concentrate draw and/or foaming action, replace lid assembly. See component chart below.



Parts List:

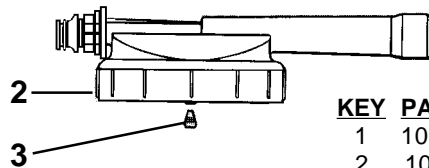

KEY	PART NO.	DESCRIPTION
1	10083713	Spray nozzle & quick disconnect
2	10061501	Foamer lid assembly
3		Metering tip kit
4	500808	Suction tube, 8"
5	609600	Foot strainer
6	688202	Concentrate container - 48 oz.

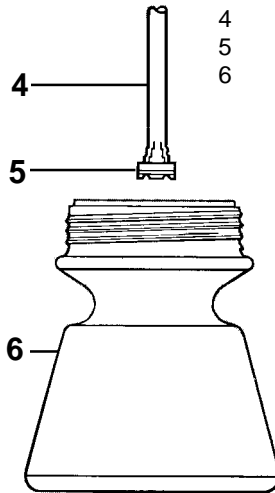

877-TRY-EZAL

www.ezall.com

90084710
Rev. A 4/05